

DNP



DIGITAL PHOTO PRINTER

DP-ID600

User Manual

EAC

- Safety precautions

Note that the contents of directions for use and safety precautions correspond to the safety standards as of the time this manual has been created.

- Remodeling

For safety, do not remodel this product after purchase.

- Copyrights

Copyrights, trademarks or any other intellectual property rights whatsoever that pertain to documents, programs or other items provided with this product, are ascribed to Dai Nippon Printing Co., Ltd., or the respective other holders of rights. Except in cases permitted by applicable laws, these may not be duplicated or used without consent from Dai Nippon Printing Co., Ltd.

WARNING

To reduce the risk of fire or electric shock, do not expose this apparatus to rain or moisture. To avoid electrical shock, do not open the cabinet. Refer servicing to qualified personnel only.

This apparatus must be earthed.

For pluggable equipment, the socket-outlet be installed near the equipment and shall be easily accessible.

To disconnect the main power, unplug the AC IN connector.

When installing the unit, incorporate a readily accessible disconnect device in the fixed wiring, or connect the power plug to an easily accessible socket-outlet near the unit. If a fault should occur during operation of the unit, operate the disconnect device to switch the power supply off, or disconnect the power plug.

Warning on power connection

Use a proper power cord for your local power supply.

1. Use the approved Power Cord (3-core mains lead) /Appliance Connector / Plug with earthing-contacts that conforms to the safety regulations of each country if applicable.
2. Use the Power Cord (3-core mains lead) / Appliance Connector /Plug conforming to the proper ratings (Voltage, Ampere).

If you have questions on the use of the above Power Cord/Appliance Connector/Plug, please consult a qualified service personnel or the distributor.

For the Customers in Europe

This product shall not be used in the residential area.

This is a Class A product. In a domestic environment, this product may cause radio interference in which case the user may be required to take adequate measures.

Hereby, [Dai Nippon Printing Co., Ltd.] declares that the radio equipment type [DS-RX1] is in compliance with Directive 2014/53/EU.

The full text of the EU declaration of conformity is available at the following internet address:

<http://www.dnpphoto.eu/en/support-and-downloads/declaration-conformity>

frequency band in which the radio equipment operates; 13.56 MHz \pm 7 kHz

maximum radio-frequency power transmitted in the frequency band in which the radio equipment operates;

48.7 dBuV/m at 3 m

If you want to dispose this product, do not mix with general household waste.

There is a separate collection system for used electronics products in accordance with legislation under the WEEE Directive and is effective only within European Union.

For details, consult your dealer.



For kundene i Norge

Dette utstyret kan kobles til et IT-strømfordelingssystem.

dansk

Hermed erklærer [Dai Nippon Printing Co., Ltd.], at radioudstyrstypen '[DS-RX1]' er i overensstemmelse med direktiv 2014/53/EU.

EU-overensstemmelseserklæringens fulde tekst kan findes på følgende internetadresse: <http://www.dnpphoto.eu/en/support-and-downloads/declaration-conformity>

Nederlands

Hierbij verklaar ik, [Dai Nippon Printing Co., Ltd.], dat het type radioapparatuur '[DS-RX1]' conform is met Richtlijn 2014/53/EU.

De volledige tekst van de EU-conformiteitsverklaring kan worden geraadpleegd op het volgende internetadres: <http://www.dnpphoto.eu/en/support-and-downloads/declaration-conformity>

suomi

[Dai Nippon Printing Co., Ltd.] vakuuttaa, että radiolaitetyyppi '[DS-RX1]' on direktiivin 2014/53/EU mukainen.

EU-vaatimustenmukaisuusvakuutuksen täysimittainen teksti on saatavilla seuraavassa

internetosoitteessa: <http://www.dnpphoto.eu/en/support-and-downloads/declaration-conformity>

ελληνικά

Με την παρούσα η [Dai Nippon Printing Co., Ltd.], δηλώνει ότι ο ραδιοεξοπλισμός [DS-RX1] πληροί την οδηγία 2014/53/ΕΕ.

Το πλήρες κείμενο της δήλωσης συμμόρφωσης ΕΕ διατίθεται στην ακόλουθη ιστοσελίδα στο διαδίκτυο: <http://www.dnpphoto.eu/en/support-and-downloads/declaration-conformity>

magyar

[Dai Nippon Printing Co., Ltd.] igazolja, hogy a '[DS-RX1]' típusú rádióberendezés megfelel a 2014/53/EU irányelvnek.

Az EU-megfelelőségi nyilatkozat teljes szövege elérhető a következő internetes címen: <http://www.dnpphoto.eu/en/support-and-downloads/declaration-conformity>

italiano

Il fabbricante, [Dai Nippon Printing Co., Ltd.], dichiara che il tipo di apparecchiatura radio '[DS-RX1]' è conforme alla direttiva 2014/53/UE.

Il testo completo della dichiarazione di conformità UE è disponibile al seguente indirizzo Internet:

<http://www.dnpphoto.eu/en/support-and-downloads/declaration-conformity>

norsk

Herved erklærer [Dai Nippon Printing Co., Ltd.] at radioutstyrstypen [DS-RX1] er i samsvar med direktiv 2014/53/EU.

Den fulle teksten til EU-samsvarserklæringen er tilgjengelig på følgende internettadresse: <http://www.dnpphoto.eu/en/support-and-downloads/declaration-conformity>

português

[Dai Nippon Printing Co., Ltd.] niniejszym oświadcza, że typ urządzenia radiowego '[DS-RX1]' jest zgodny z dyrektywą 2014/53/UE.

Pełny tekst deklaracji zgodności UE jest dostępny pod następującym adresem internetowym:

<http://www.dnpphoto.eu/en/support-and-downloads/declaration-conformity>

svenska

Härmed försäkrar [Dai Nippon Printing Co., Ltd.] att denna typ av radioutrustning '[DS-RX1]' överensstämmer med direktiv 2014/53/EU.

Den fullständiga texten till EU-försäkran om överensstämmelse finns på följande webbadress:

<http://www.dnpphoto.eu/en/support-and-downloads/declaration-conformity>

Introduction

Thank you for purchasing this device.

This document explains the handling and operation required to use this printer.

Please read this document well before use.



Be sure to read “For Safe Operation” (Pg 2-4), and operate the printer correctly.

For Safe Operation

- Be sure to read this document before use. After reading, keep it in a safe place, where it can be re-read as needed.
- The warnings listed here are to ensure proper use of the device, to prevent physical injury to the customer or other persons, and to prevent property damage. Please obey these warnings.

■ About “Warning” and “Caution”

Listed below, the possible levels of injury or damage due to misuse are categorized as “Warning” and “Caution”, according to the degrees of danger involved.

 WARNING	Accidents caused by failure to heed the warnings accompanying this symbol could lead to serious or fatal injury.
 CAUTION	Accidents caused by failure to heed the warnings accompanying this symbol could lead to physical injury or property damage.

■ About the symbols

The symbols shown have the following meanings:



This symbol calls attention to contents of warnings and cautions.
Details are indicated in or near this symbol.



This symbol indicates prohibited actions.
Details are indicated in or near this symbol.



This symbol designates necessary actions, and relevant content.
Details are indicated in or near this symbol.



WARNING



- Use only with the designated voltage and frequency. Improper connection could cause electric shock or fire.
- Avoid overstressing outlets and using extension cords. The outlet could overheat and cause a fire.
- Do not damage, destroy, bundle, or alter the power cord. Also, placing heavy objects on, pulling on, or bending the cord excessively can damage it, and could cause a fire.
- Do not set the printer up in places with salinity or corrosive gases in the air. This could cause a fire.
- Do not block the vents. Heat could build up in the printer and cause a malfunction or fire.
- Do not stand on or place heavy objects on the printer. Also, do not use excessive force on the buttons, switches, terminals, etc. This could break the printer and cause injury to the user or others.
- Be careful to avoid injury or damages from the edges in the printer.
- Do not use this printer for applications where malfunction could be life-threatening (such as medical, space, aeronautic, or other applications that require extreme reliability).



- The printer weighs approximately 14 kg (31 lbs). When moving it, lift in a way that avoids excessive physical stress. Lifting recklessly or dropping the printer could cause injury.
- Locate the printer as close to an outlet as possible, and allow easy access to unplug the power cord in case of problems.
- If there is dust on the plug, clean it off thoroughly. It could cause electric shock or a short-out.
- If metal objects or liquids have fallen into the printer, and there is smoke, a strange odor, or any other apparent abnormality, immediately turn the power OFF, and unplug the power cord. Then contact a service representative. Do not continue using the printer if it is not operating properly. This could cause shock, short circuit, or fire.



- Be sure to attach the ground. Otherwise, it could short-circuit, causing electric shock or fire.



- Do not plug or unplug the cord with wet hands. This could cause electric shock.



- Do not open the inside of the printer, disassemble internal parts, or modify the printer. It could cause electric shock, fire, or injury, or break the printer. For internal check-ups, adjustments, or repair, please contact a service representative.
-



CAUTION



- Do not set the printer up in dusty or overly humid places. This could cause fire or electric shock, or damage the printer.
- Do not set the printer up on an unstable surface. It could fall and cause injury to the user or others.
- Do not allow foreign objects to enter the printer. They could cause electric shock, short circuit, or fire, or break the printer. If something falls into the printer, immediately turn the power OFF, and call a service representative.
- Do not open the cover while printing. This could break the printer.
- Do not spill or spray liquids or chemicals into the printer.
- When cleaning the cover, do not use thinner, trichloroethane, benzene, ketone-based cleaners, or chemically treated cloths. They could discolor or deteriorate the cover.



- At least once a year, unplug the power cord, and clean the prongs and the plug. If dust accumulates, it could cause a fire.
- When printing continuously for long periods of time in a small room, be sure to ventilate properly.
- If use is intended on a transportation vehicle (train, truck, ship, etc.), please talk to a representative in advance.
- When disposing of the printer, peripheral items, packaging, or media, please abide by local waste removal ordinances. For details, contact your local government offices.



- When unplugging the cord, grip the plug. Do not pull on the cord. It could damage the cord, and cause electric shock or fire.
- When moving the printer, be sure to unplug the power cord. Otherwise, the cord may be damaged, which could cause fire or electric shock.
- When not using the printer for extended periods of time, for the sake of safety, be sure to unplug the power cord. It could cause electric shock or fire.



- The thermal print head gets very hot. Do not touch after printing. There is a danger of burns.



- Do not touch the gear mechanisms. There is a danger of injury if fingers get caught in the spinning gears.

Cautions for Set-up

- Prior to operation, read “For Safe Operation” carefully and observe the rules therein.
- Use care when moving the printer. Never try carrying the printer alone. Dropping it could cause injury or damage to other property.
- Do not use or store the printer near fire, excessive moisture, in direct sunlight, near an air conditioner or heater, or any other source of unusually high or low temperature or humidity, or excessive dust.
- Do not place the printer where chemical reactions occur, such as in a laboratory.
- Do not set up the printer where there is salinity or corrosive gas in the air.
- The printer must sit on a firm level surface where there is ample ventilation.
- Do not put anything on the top of the printer.
- Do not place the printer near a radio or television, and do not use the same wall outlet for the printer and radio or television. Radio or television reception could be adversely affected.
- Do not use a power voltage or frequency other than those specified.
- Do not put anything on the power cord or step on it.
- Do not drag or carry the printer by the power cord or USB cable.
- Avoid plugging the power cord into an outlet with many loads.
- Do not bundle the power cord.
- Always grip the plug housing, not the cord, to plug/unplug the power cord.
- Make certain the power is turned off before connecting/disconnecting the USB cable.
- Avoid lengthening the signal cable or connecting it to any noise-producing device. If it is unavoidable, use a shielded cable or twisted pair for each signal.
- Use a USB cable with shielding suitable for the USB 2.0 specification.
- Place the printer near the outlet where the power cord can be unplugged easily to shut off power.
- Use an AC outlet that accepts a three-pronged plug. Otherwise, there may be danger of electric shock.
- Use the appropriate specified cord set.
- Do not apply the power cord set coming with this product to other uses.
- Use the power cord set packaged together with this product.
- Use the appliance certified as meeting the safety standards of the country you are in.

Table of Contents

Introduction	4
For Safe Operation	4
Cautions for Set-up.....	7
Table of Contents	8
Setting Up the Printer	
Checking the Contents	9
Names of Components	10
Connecting	11
Paper, Ribbon	12
Setting the Media	13
Setting the Scrap Box	16
Setting the Paper Tray	16
Trouble-shooting	
Error Displays	17
Solving Media Errors	18
Cleaning	
Platen Roller	21
Thermal Print Head	21
Repacking	22
Specifications	23

Setting Up the Printer

Checking the Contents

Please check that the printer and all printer accessories are included in the package.



Printer Unit



Power Cord



Paper Tray

(Only for PC sizes)



For Safe Operation
(*) Start-up Guide (*)



Paper Holder

When using, remove the Protective pad.

Please keep the package box and packing material for transportation.



Protective pad



CAUTION

- When removing the printer from its package, carrying it, or moving it, be sure to use care. Dropping the printer could result in personal injury or damage to other items.
- If the printer is lifted by grasping the cushions, the cushions could break and cause the printer to be dropped.

Names of Components

[Front of Unit]

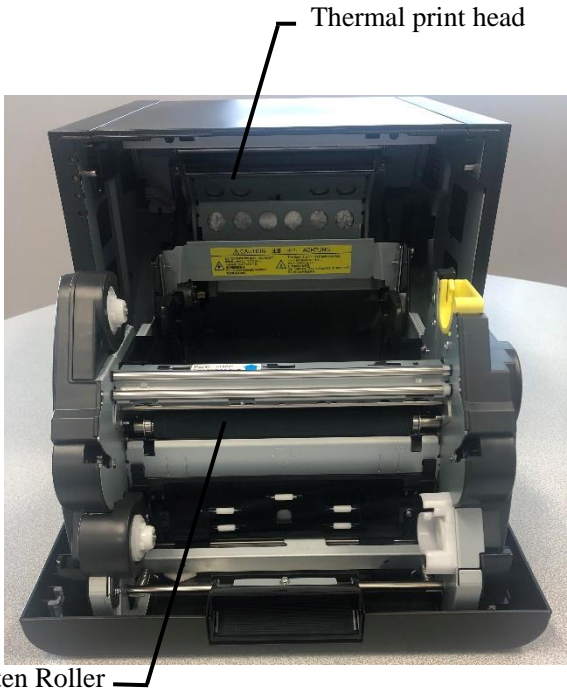

[Back of Unit]

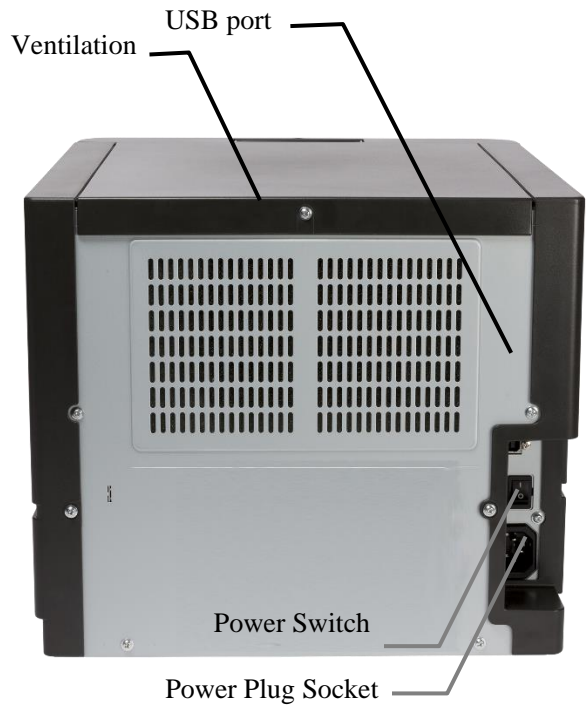

[Side of Unit]

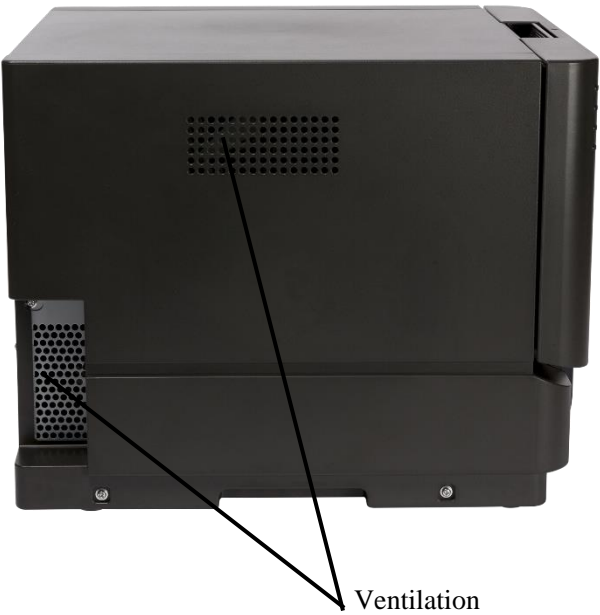

- Please be careful not to hurt yourself or damage anything on the edges of the printer.

Connecting

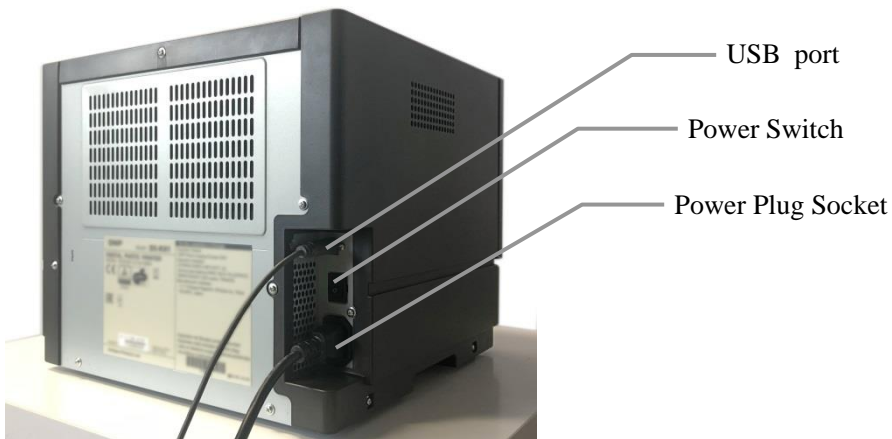

1. Make sure that both the printer and tablet power switches are set to the OFF position.
2. Plug the cord connector end into the printer Power Plug Socket.
3. Plug the cord into the wall outlet.
4. Connect the USB cable to the printer and the tablet.
5. Turn on the power of the printer and the tablet.



CAUTION

- Please use the power cable that came with the printer, and be sure to attach the ground wire.
- Use a USB cable with shielding suitable for the USB 2.0 specification. Otherwise unexpected troubles may arise.

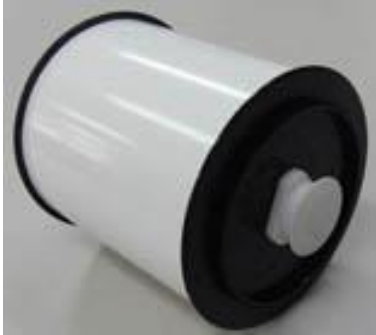
Paper, Ribbon

Type	PC (6x4) for ID
Paper	
	Width: 152mm
Ribbon	
	Width: 159mm

**CAUTION**

- Set the paper and ribbon without putting them directly on the work surface. Any dust or dirt could get inside the printer and adversely affect the print quality.
- With a new roll of paper, the paper holder weighs approx. 2.6 kg (6 lbs). If dropped, it could cause injury. It could also damage the paper holder.

Setting the Media

1. Release the Open Lever, and open the front cover.

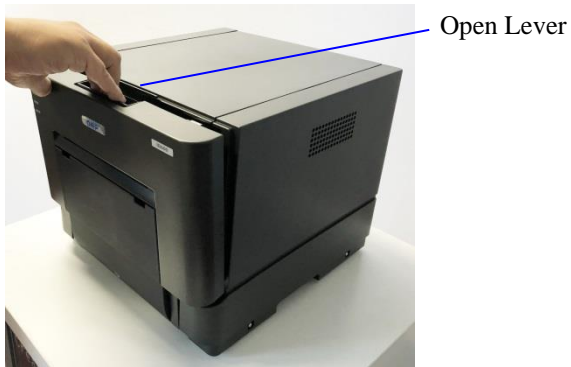

2. Set the paper to the paper holder.
When setting it, make sure there are no gaps between the paper and the holder.
Make sure the paper is not sticking out. If the end of roll is uneven (with paper sticking out), remove it from the holder, and flatten it.

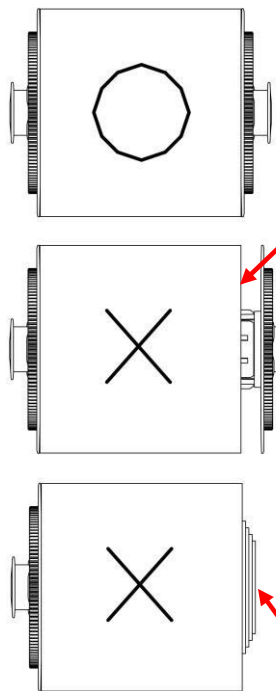

No gaps

Check for uneven ends



3. Set the paper into the printer.



Setting Up the Printer

4. Remove a paper fixed tape, and Insert the paper.

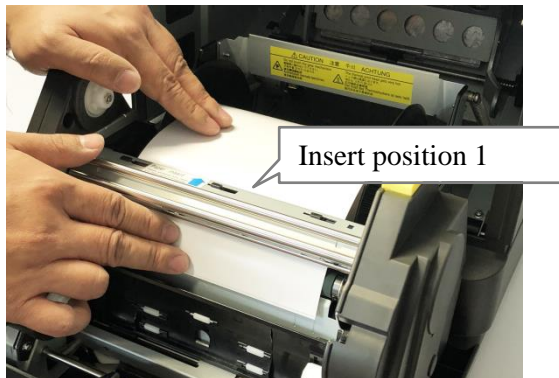

5. Fit the paper to the proper position for each size.
PC size correspond to the line of PC.

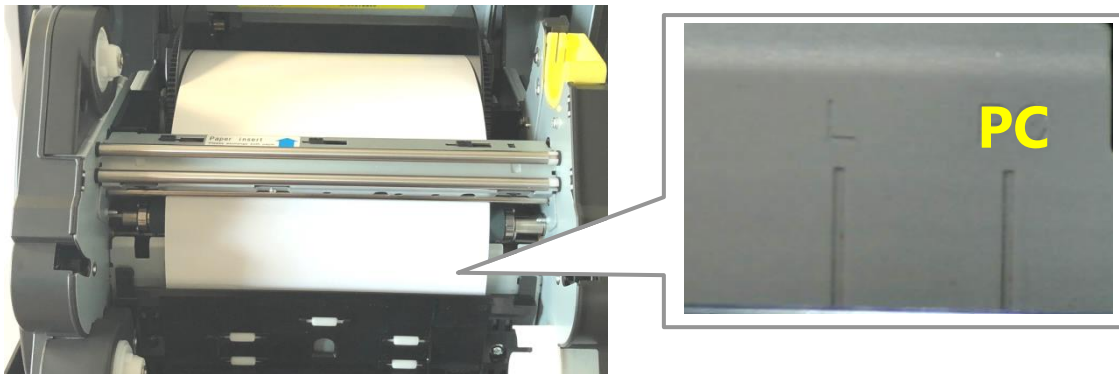

6. Insert the paper under the black paper guide until the buzzer beeps (approx. to the dotted line). Make sure to insert the paper straight. If it isn't inserted straight, the paper will be crooked, which could cause white line on the edges of the print, ribbon wrinkles, and register slippage.

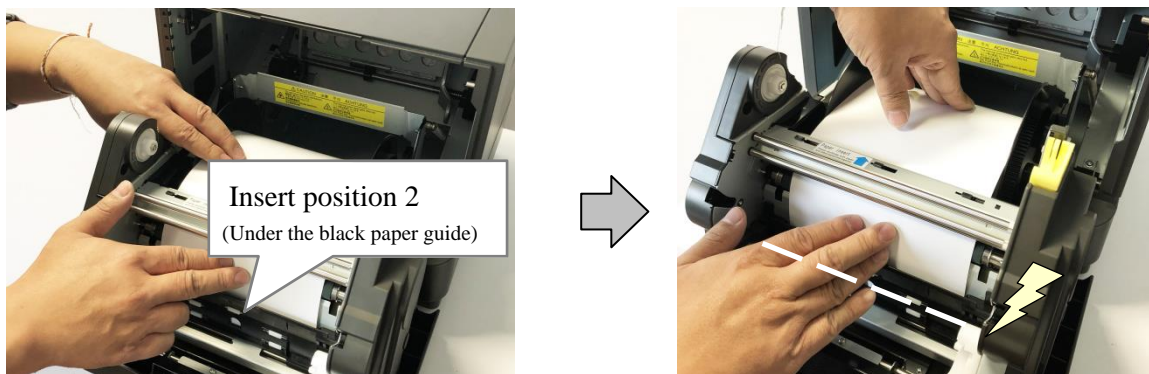

Setting Up the Printer

7. Set the take-up side core of the ribbon to the printer. Insert the protrusion of the core left side in the hole on the printer, then set the right side to the holder of the same color (yellow).

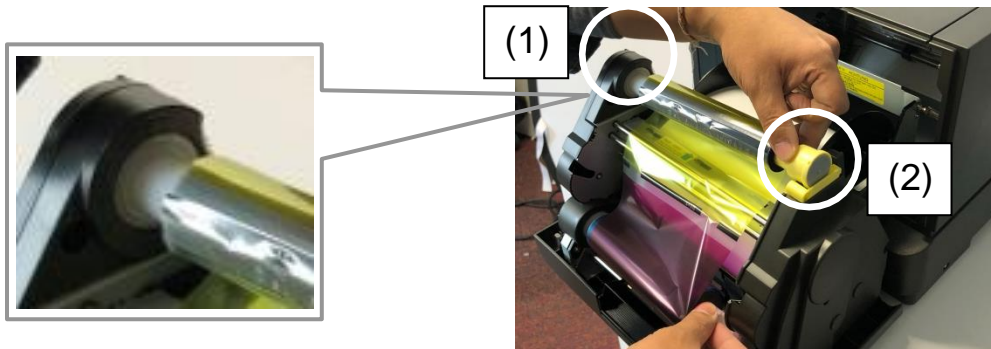

8. Set the supply side of the ribbon to the printer carefully to take out any slack. Insert the protrusion of the core left side in the hole on the printer, then set the right side to the holder of the same color (white). Take up the ribbon slack by rotating the ribbon on the supply side.

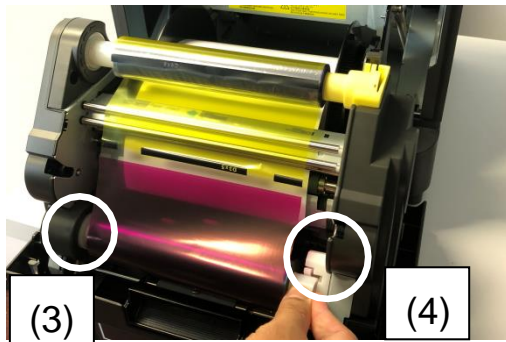

Ribbon winding direction

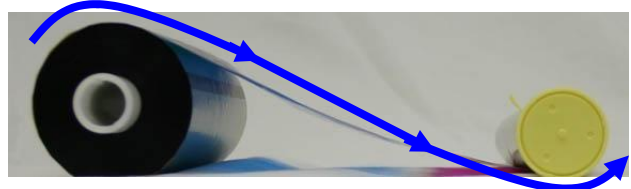

9. Close the front cover.
When the front cover is closed, the paper initialization process will be carried out (5 blank sheets will be fed out).



Setting Up the Printer

*In order to facilitate media color adjustment, media type recognition, and print quantity management, an IC chip is built into the ink ribbon. Media without an IC chip, which has not been evaluated and cleared, may not function properly. (If correct data cannot be read from the IC chip, an alarm will sound. In this case, in order to protect the printer, it will lower the concentration for printing.)

*Please change the media as a set, because the IC chip for each ribbon has unique information. Otherwise, errors could occur.

*If different width media are used on the same printer, problems with the print quality could arise. Therefore, it is preferable not to mix the use of different width media on one printer.

Setting the Scrap Box

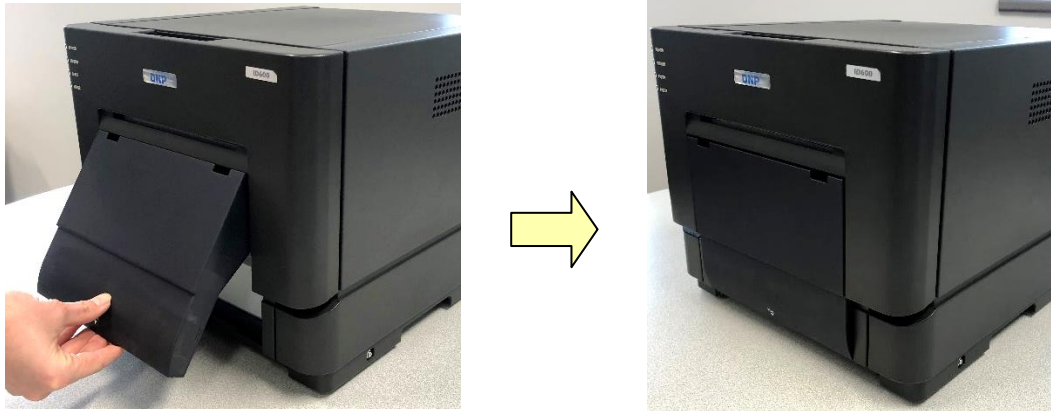

CAUTION

- When the scrap box is removed, do not insert your fingers in the cutter at the top. They could be cut or severed.
- As prints are cut, the scrap box fills with scrap paper. Be sure to empty it when you change the paper and ribbon. If it becomes over-filled with scraps, it could cause problems with the printer.
- Exchange the paper and ribbon as a set, in order to avoid a trouble.

Setting the Paper Tray

1. Attach the Paper Tray to the Scrap Box.

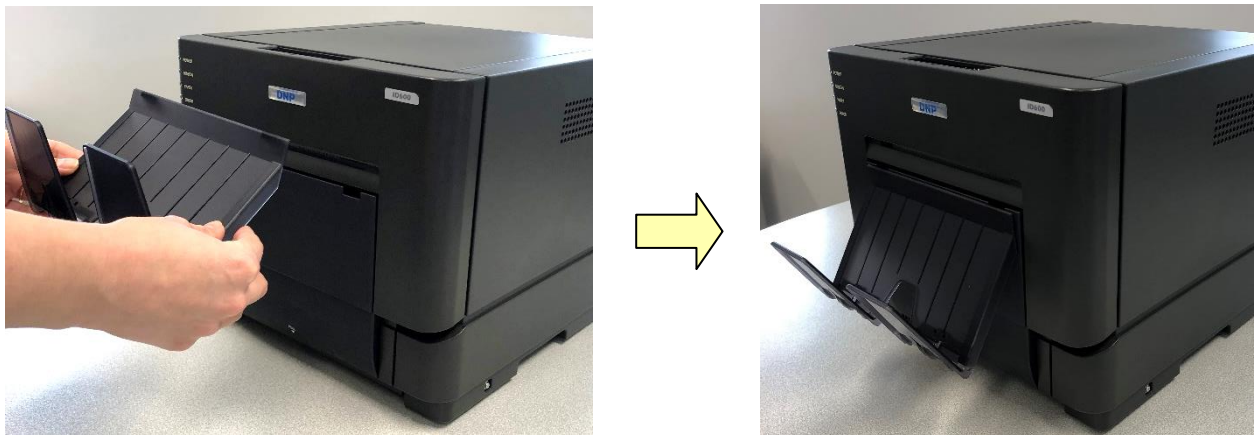

Paper Tray

*The tray can hold about 50 photos, but please remove them frequently.

*Remove the printouts frequently particularly when using 2x6 paper sheets.

CAUTION

- Use with sizes other than L or PC, or allowing too many photos to accumulate could cause problems. Moreover, there is a possibility that a paper tray may be damaged.
- Open and close a paper tray softly. There is a possibility of damaging if unreasonable power is applied.

Error Displays



The flashing LED indicates the printer status

Status	LED display				Solution
	Power	Ribbon	Paper	Error	
Paper End *1	●		⚡		Put in a new roll of paper
Ribbon End *1	●	⚡			Put in a new roll of ribbon
Door is Open (No paper)	●		⚡	⚡	Set the paper properly and close the front cover
Door is Open	●			⚡	Close the front cover
Paper Error	●		●	●	Free the paper, and reset it correctly
Ribbon Error	●	●		●	Fix the ribbon, and set it correctly
System Error	●			●	Re-boot the printer (turn off, then on)
Head Cool Down	⚡				The head is cooling off (auto-recovery)

*● indicates lit, ⚡ indicates flashing, and blank is not lit

*1 Exchange the paper and ribbon as a set.

Solving Media Errors

1. Release the Open Lever, and open the front cover.
2. Remove the ribbon._

a. If the paper is jammed:

1. Pull out any paper remaining in the printer, and cut off any wrinkled or partially printed areas evenly with scissors.
Printing over an already printed area will cause the ribbon to stick, and the paper will jam again.
When pulling the paper out, pull it slowly. Application of too much force could damage the printer.

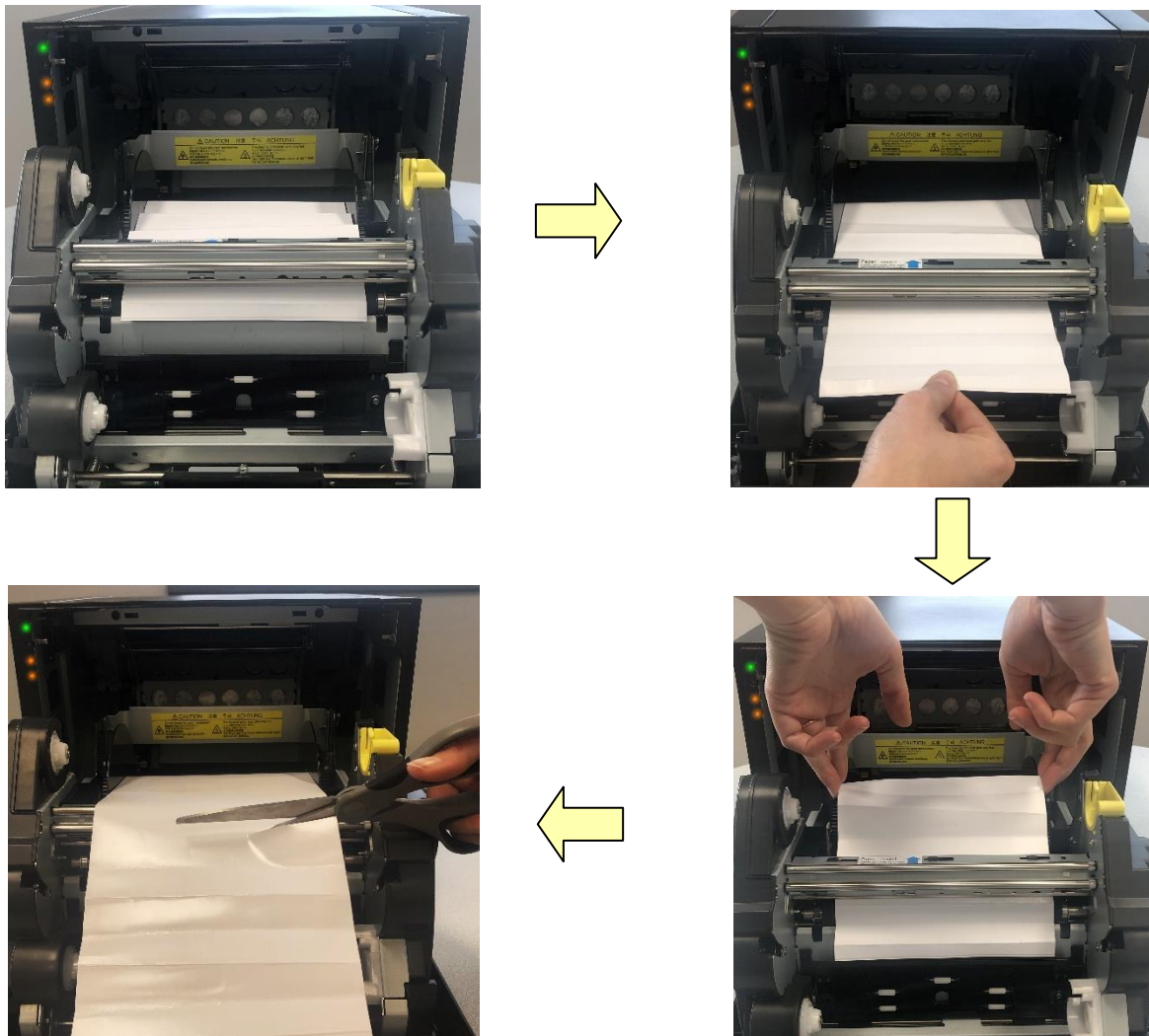

Cutting the paper

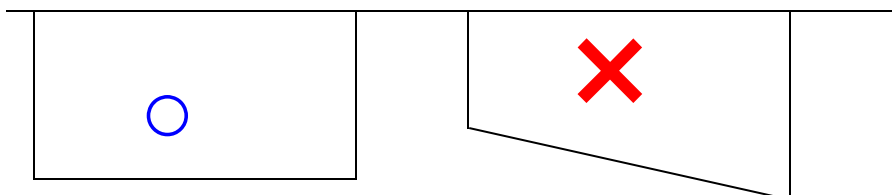

If the paper is not cut evenly, it may cause abnormal printing and or the paper to jam.
Then follow the methods as for setting the media (P.13).

b. If the ribbon is cut:

1. Remove any ribbon remaining in the printer.



2. Remove any incomplete prints.
If the next image is printed over the previous image, the ribbon may stick, and it may cause the paper to jam.
3. Reattach the ribbon with cellophane (or similar) tape.



Attach with tape

4. Set the ribbon into the printer.
5. Rotate the take-up side of the ribbon several times until the tape is out of sight.

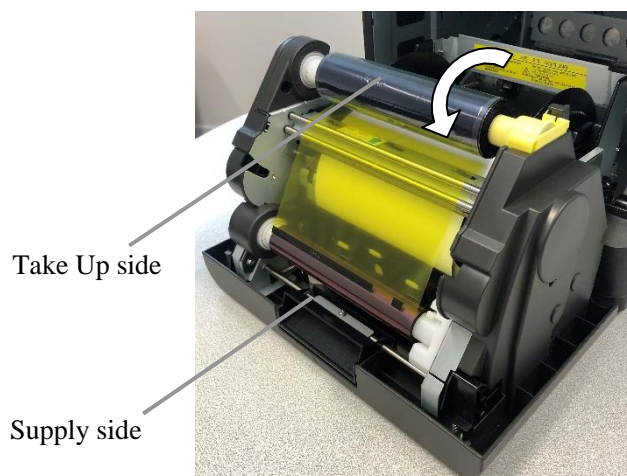

Then follow the methods as for setting the media (P.13).

c. If the printer is stopped in the middle of cutting:

1. Turn the power back ON. Jammed paper is cleared, and the cutter blade returned to its ready position.

If the jammed paper cannot be freed, please contact a service representative.

2. Remove any partially printed material from inside the printer.

Then follow the methods as for setting the media (P.13).

d. If power is cut during printing:

* If the power is cut during printing, you will not be able to open the front cover.

1. Turn the power back ON. The partial print will be cut into scrap-size pieces and removed.
After this, you will be able to open the front cover.
2. Check that there is no printed material in the printer.
If the paper is jammed, refer to a. If the paper is jammed. (P.18)



CAUTION

- Do not turn the power OFF while printing. This could damage the printer.

Platen Roller

If there is an indent on the pictures at a regular interval, or if the back of the picture (white side) is dirty, clean the platen roller.

There may be dust, grime, adhesives, etc. from the ribbon or paper on the platen roller.

1. Prepare a piece of gauze or other soft cloth soaked in ethyl alcohol.
Benzenes or thinners other than ethyl alcohol may permeate the resin, so they should not be used.
2. Wipe off any grime while turning the platen roller.



Thermal Print Head

When dirt has adhered to the print head, the unevenness of print and the poor fixation of print may occur.

1. Prepare a piece of gauze or other soft cloth soaked in ethyl alcohol.
2. Wipe the thermal print head gently, without touching the thermal print head by the direct hand.



CAUTION

- Never use benzenes or thinners other than ethyl alcohol, as they may permeate the resin.
- Before cleaning, always switch off the printer. Otherwise, there is a possibility of becoming causes, such as an injury and a burn.
- The thermal print head will be hot just after printing. Please wait for the print head to cool off before beginning cleaning.

Repacking

Transporting the printer requires the reuse of the original packing materials. The printer must be packed in the same way it was at the time of purchase. If the original packaging materials are not used and the printer is not packed correctly, the printer may be broken during transport.

Remove all Accessories and Attachments from the printer (print media ink ribbon, paper roll and holders, USB cable, power cable and paper tray) and store or transport them separately.

Please save the Print Head Protective Pad and do not throw away any packaging as you will need them to safely transport the printer.

Place the sides marked TOP face up.

↓ Match the printer orientation with the arrows.

Make sure to install for transportation.

Print Head Protective Pad is REQUIRED for transportation.

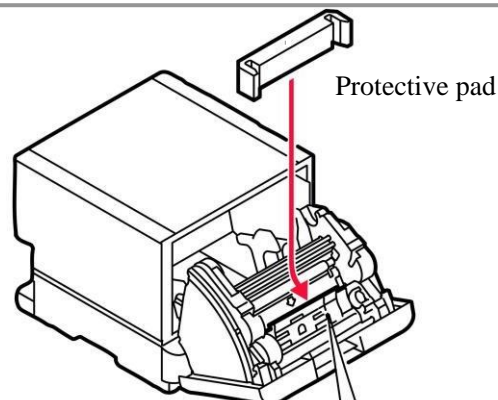
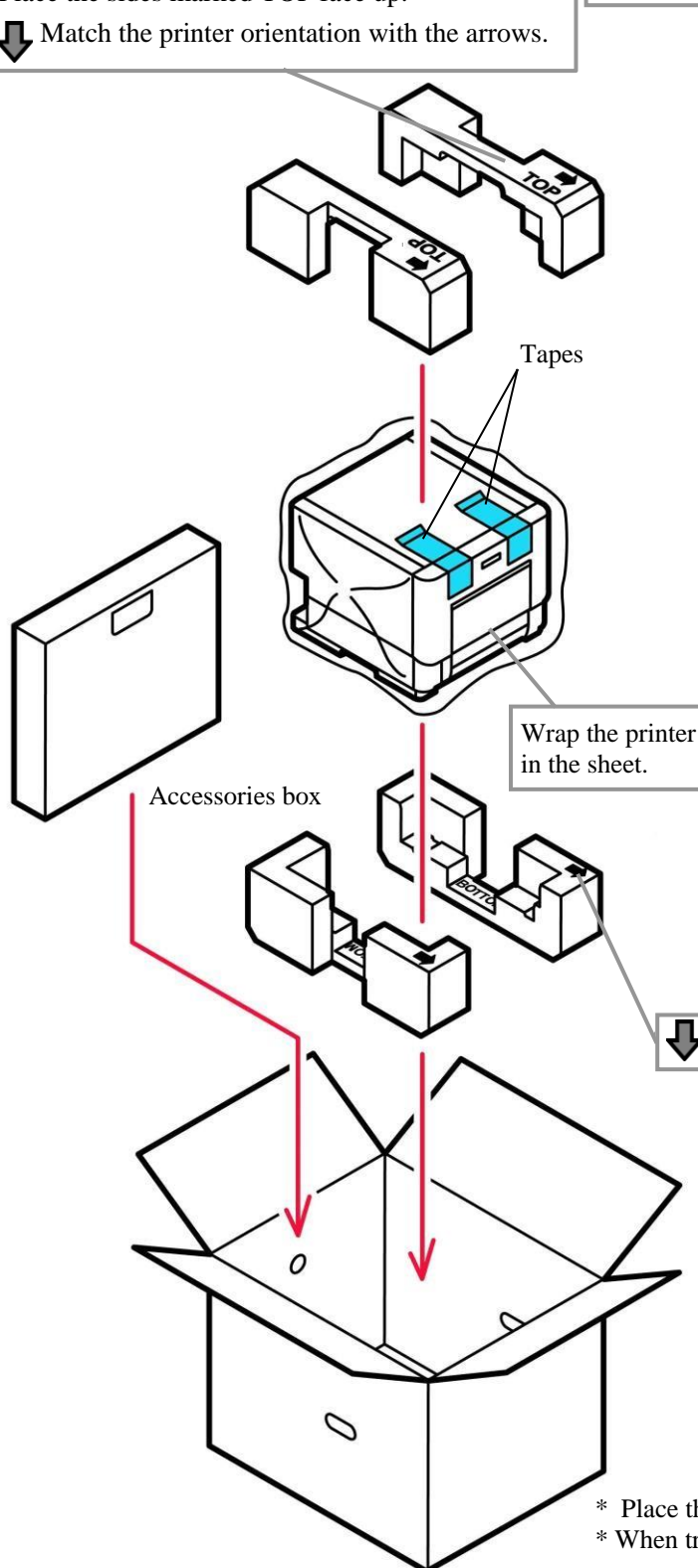

During transportation, secure the front opening (minimum length 200 mm or more)

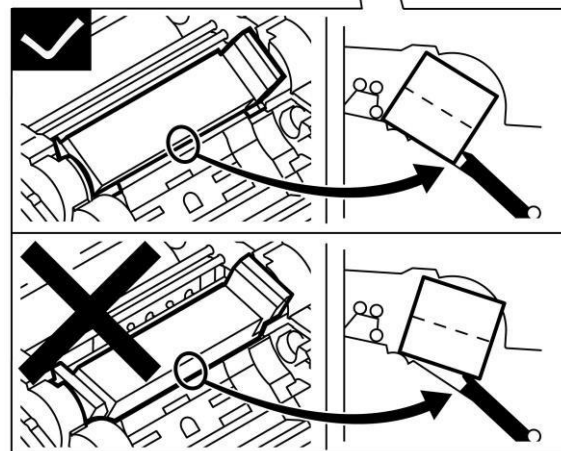

↓ Match the printer orientation with the arrows.

* Place the attachments in the accessories box.

* When transporting be sure to include the accessories box.

Specifications

Item		Specific
Power		100 to 240V AC, 50/60 Hz
Input current		2.9 to 1.2 A
Operating temperature		5 to 35 °C
Operating humidity		35 to 80 % (no condensation)
External Dimensions		Approx. 322 × 281 × 351 mm (W×H×D) (excluding the maximum projecting parts)
Mass		Approx. 13.8 kg (printer only)
Printing system		Dye sublimation thermal transfer
Ribbon type		Y + M + C + overcoat
Printing mode		High-speed mode
Resolution		11.8 × 11.8 dot/mm (300 × 300 dpi)
Print-size	PC (6×4)	Approx. 101×152 mm
Print-capacity	PC (6×4)	350 sheets
Printing time	PC (6×4)	Approx. 14.9 sec
Interface		USB2.0 (max 480Mbps) Type-B connector

*These specifications may be changed without prior notice.

Information on servicing the printer

For information on use and repair service of the units, please contact your sales agent.

Dai Nippon Printing Co., Ltd.